

Ulti Duo Therm

DOUBLE INSULATED HIGH PERFORMANCE DOOR

Any application requiring an enhanced level of environmental separation is ideally served by the Ulti Duo Therm. The innovative double insulated curtain system delivers increased energy savings, with outstanding thermal insulation and acoustic performance. This door can be applied to almost any entrance from a -35C cold store or a heated product processing room.

Thermal Performance

At the heart of the Ulti Duo Therm door design is the innovative double curtain design. When closed, the two curtains create a dead air space, which is treated with a small amount of warmed air, for ultimate insulation. Double curtain, double insulation, double the energy savings.

Speed Where it Matters

The Ulti Duo Therm has a standard opening speed of up to 1.8m per second. This enhanced speed is vital in minimising energy loss, while also ensuring the door outperforms any approaching traffic, maximising productivity, and minimising the chance of impact damage from forklifts.



Ideal for use in

- Refrigeration Industry
- Heated Facilities
- Environmental Loading Areas
- Chiller/Freezer Openings
- Supermarkets
- Food Manufacturing
- Chilled Logistics

Crash Resistant

The innovative curtain edge profile allows rapid movement within the self-lubricating polyethylene tracks, and also allows the curtains to unzip from the guides in the event of an accidental impact, minimising damage to the door.

With a 2-metre high tower beam safety sensor, photocell safety beams, soft PVC bottom edge, and a dual reversing sensor system, the Ulti Duo Therm is inherently safe, but in the event of any accidental impact which has caused the door curtain to release from the guides, auto re-feed slots will automatically re-feed the curtain on the next cycle, minimising downtime and maintenance costs.

Versatile

With its compact design, quiet operation, and multiple upgrade options, the Ulti Duo Therm is versatile and can be easily incorporated into restricted building clearances, and into unique applications that are well beyond the market standard.

Multi-Industry Applications

The Ulti Duo Therm outperforms traditional freezer door types and can be applied to larger openings than other alternatives. Selecting the 7mm Insulated Curtain option also allows you to further upgrade the thermal resistance and insulation factor of the door, increasing the energy savings and decreasing the carbon footprint of your facility.



STANDARD COMPLIANCE

| | | | |
|-------------------|---------|-----------------------|-----------------------|
| Wind Permeability | Class 1 | Water Permeability | Class 1 |
| Wind Loading | Class 2 | Thermal Transmittance | 2.0W/m ² K |
| Safe Openings | Yes | Pressure Differential | Up to 60Pa |

TECHNICAL SPECIFICATIONS

| | |
|-----------------------|---------------------|
| Application | Internal/External |
| Standard Size | 3500mm H x 4000mm W |
| Minimum Size | 2000mm H x 2000mm W |
| Maximum Size | 7000mm H x 6000mm W |
| Opening Speed | Up to 1.8m/s |
| Closing Speed | 0.8m/s (variable) |
| Operating Temperature | -25°C to +50°C |

STRUCTURE

| | |
|----------------|------------------|
| Frame Material | Galvanised Steel |
| Frame Colour | RAL9010 |

SPACE REQUIREMENTS

minimum clearances

| | |
|----------|--------------------------------------|
| Headroom | 1000mm |
| Sideroom | 450mm (motor) 180mm (non-motor side) |

CURTAIN

| | |
|----------|--|
| Material | 3.5mm Insulated Reinforced PVC Curtain |
| Colour | RAL7042 (standard), RAL9003 |

DIMENSIONS

NOTE:
ORDER DOORS BY CLEAR
OPENING DIMENSIONS
REQUIRED

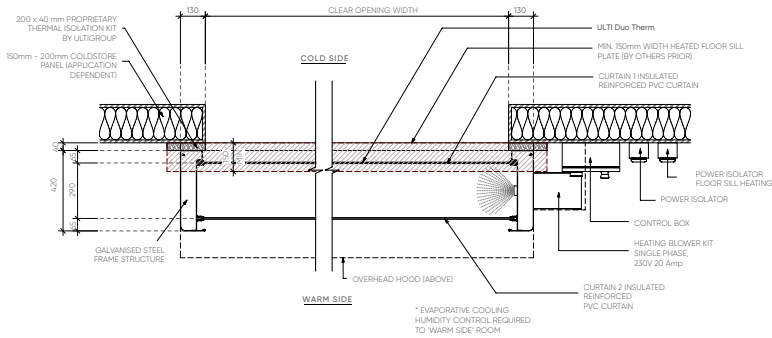

FLOOR PLAN VIEW

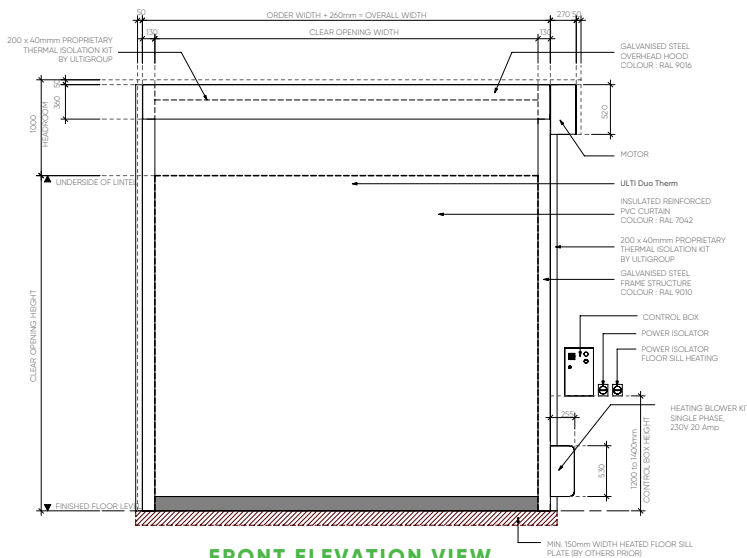

FRONT ELEVATION VIEW

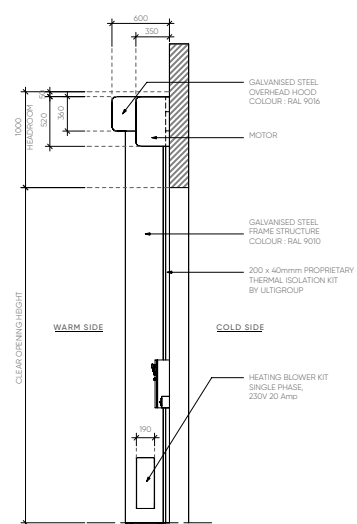

SIDE ELEVATION VIEW

MOTORISATION

| | |
|----------------------|---|
| Motor | IP54 rated 1.5kW Heavy Duty 3phase Motor Drive and electromagnetic brake – RH mounted |
| Motor Position | RH Side |
| Control Panel | IP54 rated Metal Control box with inverter frequency controller – RH mounted |
| Power Supply | 400V; 3phase+N+E; 15Amp Rated adjacent to control box installed to right hand side |
| Heating Power Supply | 230V; Single Phase; 20Amp |

ACTIVATIONS

| | |
|--------|---|
| Manual | Large Heavy-duty Mushroom Head push button Push button and Emergency stop button fitted to control box |
|--------|---|

SAFETY

| | |
|---------------------|--|
| Standard Inclusions | 1 Set of Infrared Photocell Safety beams IP65 Soft PVC Bottom Edge LED Countdown Timer in Control box Reversing sensor system for door curtain obstructions |
| >2500mm High Doors | 2000mm H tower beam safety sensors IP67 |
| <2500mm High Doors | Infrared photocell safety beams IP65 |
| Emergency Egress | Manual Hand Crank |

STANDARD INCLUSIONS

Air Circulation Unit
Performance Rated to 1,000,000 cycles
Re-Feed slot (up to 3500mm W)
Heated Frame – 240V Heat tracing for Door frame and Thermal Isolation mounting system for Freezer Applications (mandatory when -10C)
Lintel Brush Seal

WARRANTY

24 Months or 100,000 Cycles
*Std Warranty terms and conditions apply

OPTIONAL FEATURES

| | |
|-------------------|--|
| Activations | All Ulti Activation options can be applied |
| Motorisation | IP65 Rated 1.5kw Motor with Stainless Brake (for corrosive applications) |
| Mounting Options | LH Power Supply, Custom Control Box Position, LH Control Box, LH Motor, Front Mount Motor |
| Power Supply | Ulti Controller Single Phase |
| Safety | Virtual Vision, Extended LED Countdown Timer LED Pre-Announce |
| Frame Colours | RAL3000, RAL5002, RAL6018, RAL7042, RAL9005, Custom Colour |
| Insulated Curtain | 7mm PVC (1.3W/m ²) - Subject to application review RAL1003, RAL2004, RAL3002, RAL5002, RAL7035, RAL9010 |
| Emergency Egress | UPS Battery Backup (Single Phase) |
| Other Features | Custom Printed Curtain – Full curtain printing with photo or logo Wind retention upgrade |